

Beam clamps with RFID

Product information

The clamp can be used for example to attach a hoist to an I or T beam ... [Read more](#)



Material: Steel

Marking: According to standard, CE-marked

Finish: Painted, orange

Standard: EN 13155

Safety factor: 4:1

Beam clamps with RFID

Blueprint

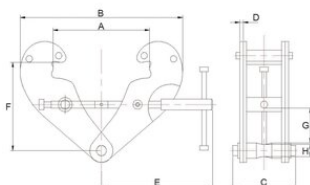

Technical data

| Part code | WLL ton | Beam width | A max mm | B max mm | C mm | D mm | E mm | F min mm | F max mm | G min mm | H mm | B min mm | Weight kg |
|------------|---------|------------|----------|----------|------|------|------|----------|----------|----------|------|----------|-----------|
| TARPALH10 | 1 | 80-240 | 270 | 183 | 94 | 4 | 198 | 100 | 154 | 22 | 20 | 370 | 3.5 |
| TARPALH20 | 2 | 80-240 | 270 | 183 | 102 | 6 | 198 | 100 | 154 | 22 | 20 | 370 | 4.5 |
| TARPALH30 | 3 | 90-330 | 355 | 243 | 132 | 8 | 263 | 148 | 219 | 46 | 22 | 500 | 9.5 |
| TARPALH50 | 5 | 90-330 | 355 | 243 | 142 | 10 | 263 | 148 | 219 | 43 | 28 | 500 | 11 |
| TARPALH100 | 10 | 90-350 | 364 | 269 | 180 | 12 | 285 | 165 | 239 | 51 | 38 | 521 | 16 |